

B16 Hood, low profile, IP65

Single locking lever, top entry M25

B16
Hood (low)
Single locking lever
IP65

Technical data will be only guaranteed with Murrelektronik components.

Link to Product

Illustration

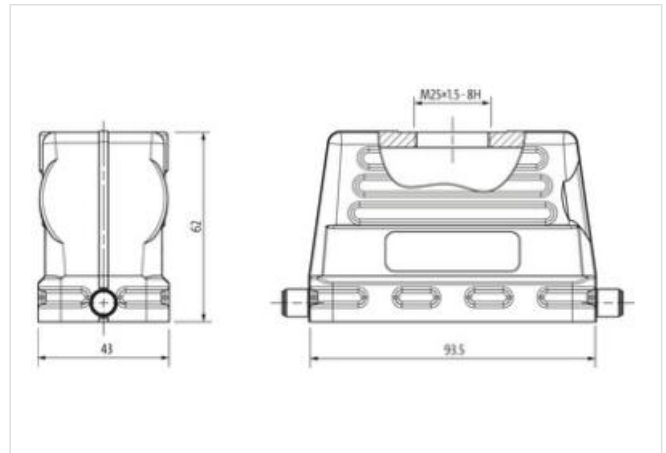

Product may differ from Image

Commercial data

| | |
|-----------------------|---------------|
| ECLASS-6.0 | 27143424 |
| ECLASS-6.1 | 27261203 |
| ECLASS-7.0 | 27440202 |
| ECLASS-8.0 | 27440202 |
| ECLASS-9.0 | 27440202 |
| ECLASS-10.1 | 27440202 |
| ECLASS-11.1 | 27440202 |
| ECLASS-12.0 | 27440202 |
| ETIM-5.0 | EC000437 |
| customs tariff number | 85389099 |
| GTIN | 4048879646673 |
| Packaging unit | 1 |

Installation

| | |
|--------------|----------|
| Cable outlet | straight |
|--------------|----------|

Installation | Connection

| | |
|--------------------|-----|
| Mounting set | M25 |
| Mating cycles min. | 500 |

Device protection | Electrical

| | |
|--|---|
| Degree of protection (EN IEC 60529) | IP65 |
| Additional condition protection degree | inserted, locked, with screw connection |

Mechanical data

| | |
|--------------|------|
| Housing type | Hood |
|--------------|------|

Mechanical data | Material data

| | |
|------------------|----------------------|
| Coating housing | powder-coated |
| Coating locking | verzinkt |
| Material housing | Aluminum die casting |
| Locking material | Steel |

Mechanical data | Mounting data

| | |
|--------------------|----------------------|
| Size | B16 |
| Height | 62 mm |
| Width | 43 mm |
| Depth | 93,5 mm |
| Locking techniques | Single locking lever |

Environmental characteristics | Climatic

| | |
|------------------------------------|-----------|
| Operating temperature min. | -40 °C |
| Operating temperature max. | 100 °C |
| Climatic category (EN IEC 60068-1) | 40/100/21 |