

M12 male recept. 0° S-cod. rear

4-pol., PCB-Pin

- PCB connectors
- Male straight
- M12, 4-pole
- S-coded
- Rear mounting
- THT-solder connection

Link to Product

Illustration

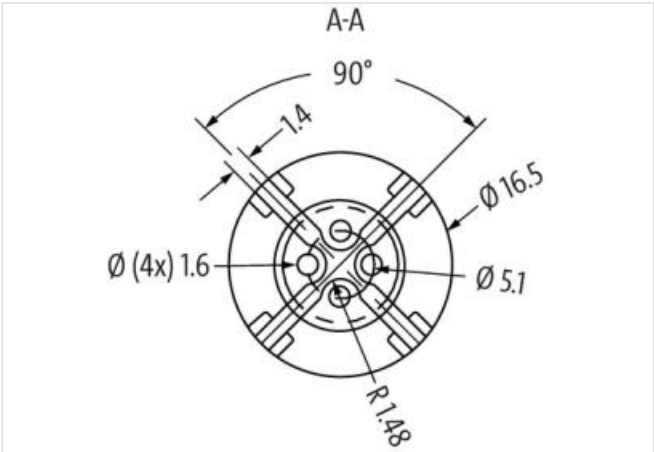
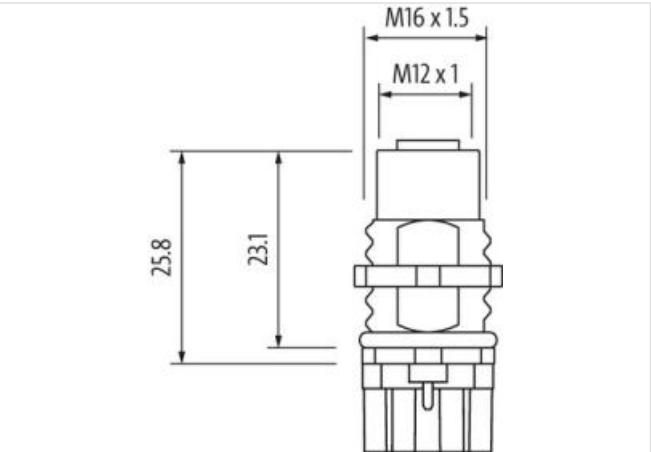
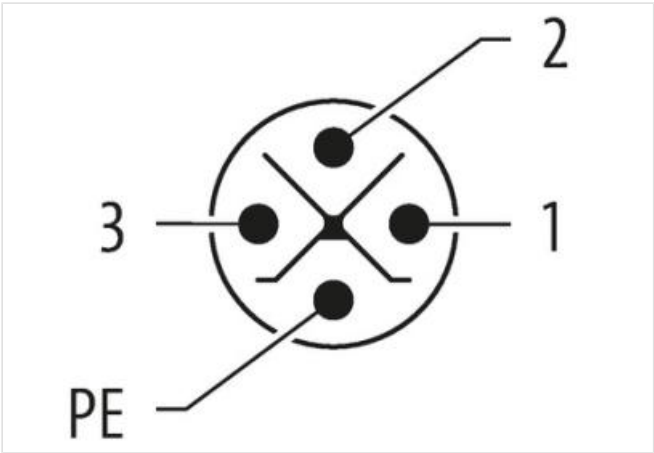

Product may differ from Image



| Side 1 | |
|--------------------------|--------------|
| Coating contact | gold plated |
| Family construction form | M12P |
| Coding | S |
| Material contact | Copper alloy |

No. of poles 4

Commercial data

| | |
|-----------------------|---------------|
| ECLASS-6.0 | 27279220 |
| ECLASS-6.1 | 27279221 |
| ECLASS-7.0 | 27440104 |
| ECLASS-8.0 | 27440104 |
| ECLASS-9.0 | 27440106 |
| ECLASS-10.1 | 27440106 |
| ECLASS-11.1 | 27440106 |
| ECLASS-12.0 | 27440106 |
| ETIM-5.0 | EC002061 |
| customs tariff number | 85366990 |
| GTIN | 4065909074695 |
| Packaging unit | 10 |

Electrical data | Supply

| | |
|---------------------------------------|-------|
| Operating voltage AC max. | 630 V |
| Operating voltage AC max. (UL-listed) | 600 V |
| Current operating per contact max. | 12 A |

Installation | Connection

| | |
|--------------------------|-----------------------|
| Connection information | THT-solder connection |
| Tightening torque | 0,6 Nm |
| Mounting set | M16 x 1.5 |
| Family construction form | M12P |
| Width across flats | SW19 |

Device protection | Electrical

| | |
|--|-------------------|
| Degree of protection (EN IEC 60529) | IP65, IP67, IP68 |
| Additional condition protection degree | inserted, screwed |
| Pollution Degree | 3 |

Mechanical data | Material data

| | |
|--------------------------|---------------|
| Coating housing | nickel plated |
| Material housing | Copper alloy |
| Material contact carrier | PA |

Mechanical data | Mounting data

| | |
|-----------------|-------------------|
| Mounting method | inserted, screwed |
|-----------------|-------------------|

Environmental characteristics | Climatic

| | |
|----------------------------|--------|
| Operating temperature min. | -30 °C |
| Operating temperature max. | 90 °C |

Important installation notes

| | |
|------------------------|---|
| Note on strain relief | Protect the connectors by suitable measures from mechanical loads, e.g. by the usage of cable ties. |
| Note on bending radius | Attention: Observe the permissible bending radii when laying cables, as the IP protection class can be endangered by excessive bending forces. |

Conformity

| | |
|------------------|-----------------|
| Product standard | IEC 61076-2-111 |
|------------------|-----------------|