

B16 Surface mounted h., IP68

Screw locking, side entry M40

B16  
Surface mounted housing  
Screw locking  
IP68  
Technical data will be only guaranteed with Murrelektronik components.

Link to Product

Illustration



Product may differ from Image

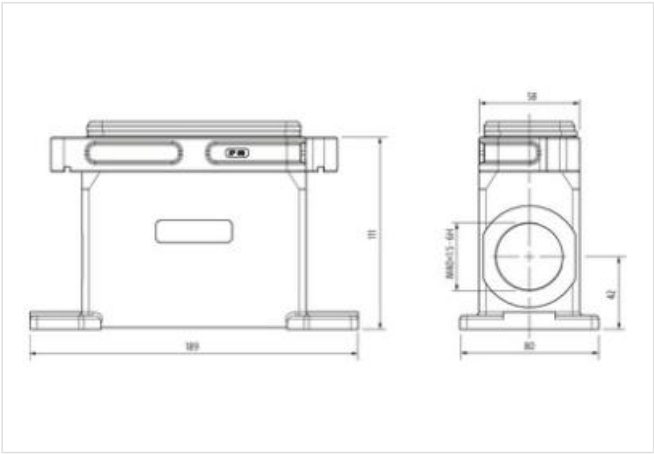

Commercial data

ECLASS-6.0	27143424
ECLASS-6.1	27261203
ECLASS-7.0	27440202
ECLASS-8.0	27440202
ECLASS-9.0	27440202
ECLASS-10.1	27440202
ECLASS-11.1	27440202
ECLASS-12.0	27440202
ETIM-5.0	EC000437
customs tariff number	85389099
GTIN	4048879647410
Packaging unit	1

Installation

Cable outlet laterally

Installation | Connection

Mounting set	M40
Mating cycles min.	500

Device protection | Electrical

Degree of protection (EN IEC 60529)	IP68
Additional condition protection degree	inserted, locked, with screw connection

Mechanical data

Housing type Surface mounted housing

Mechanical data | Material data

Coating housing	powder-coated
-----------------	---------------

Material gasket	Silicon
-----------------	---------

Material housing	Aluminum die casting
------------------	----------------------

Locking material	Stainless steel
------------------	-----------------

**Mechanical data | Mounting data**

Size	B16
------	-----

Mounting method	Screw locking
-----------------	---------------

Height	111 mm
--------	--------

Width	80 mm
-------	-------

Depth	189 mm
-------	--------

**Environmental characteristics | Climatic**

Operating temperature min.	-40 °C
----------------------------	--------

Operating temperature max.	125 °C
----------------------------	--------

Climatic category (EN IEC 60068-1)	40/125/21
------------------------------------	-----------