

M12 female 90° field-wireable

4-pole max. 0.75mm² 4-6mm

Customized printing and packaging  
Female 90°  
M12, 4-pole  
Screw terminals  
Sealing range (cable Ø): 4...6 mm  
Plastic housings with good resistance against chemicals and oils.  
The resistance to aggressive media should be individually tested for your application. Further details on request.

Link to Product

Illustration

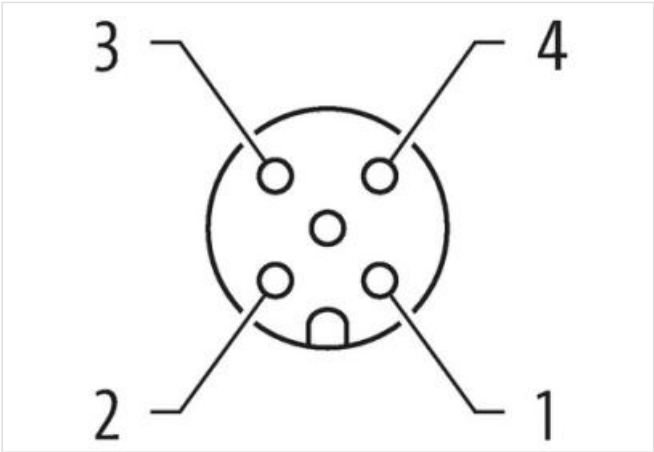
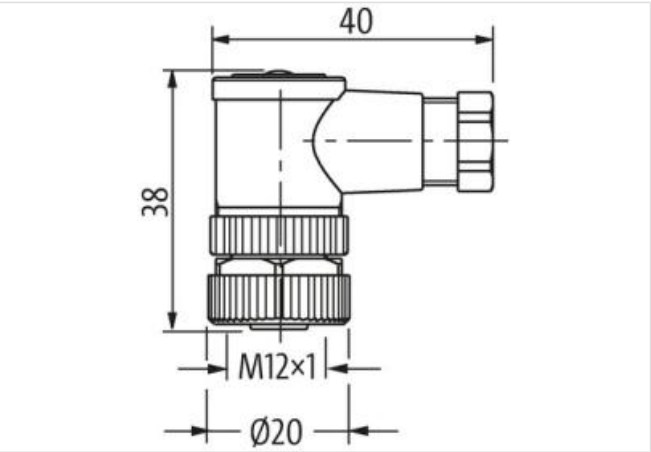
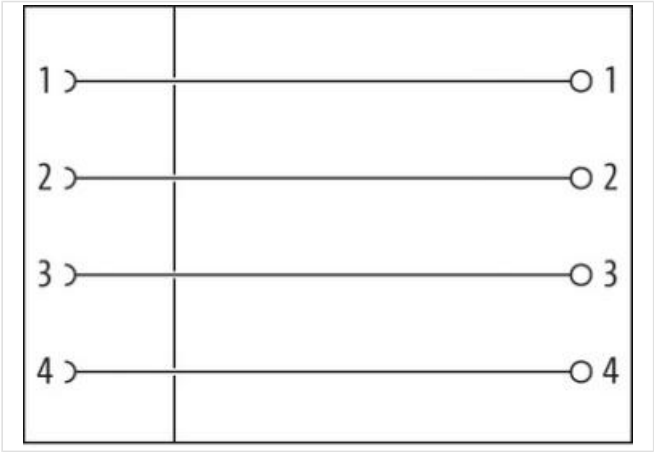

Product may differ from Image



Side 1	
Family construction form	M12
Coding	A
Material contact	Copper alloy

No. of poles	4
Degree of protection (EN IEC 60529)	IP67
<b>Commercial data</b>	
ECLASS-6.0	27279221
ECLASS-7.0	27440104
ECLASS-8.0	27440104
ECLASS-9.0	27440102
ECLASS-10.1	27440102
ECLASS-11.1	27440102
ECLASS-12.0	27440116
ETIM-5.0	EC001855
customs tariff number	85366990
GTIN	4048879848633
Packaging unit	10
<b>Electrical data   Supply</b>	
Operating voltage AC max.	250 V
Operating voltage DC max.	250 V
Current operating per contact max.	4 A
Current operating per contact max. (URc.)	3 A
<b>Diagnostics</b>	
Status indication LED	no
<b>Installation</b>	
Connection cross section max.	0,75 mm²
<b>Installation   Connection</b>	
Tightening torque	0,6 Nm
Mounting set	M12 x 1
Width across flats	SW18
<b>Device protection   Electrical</b>	
Additional condition protection degree	screwed, mounted
Pollution Degree	3
Rated surge voltage	2,5 kV
Material group (IEC 60664-1)	III
<b>Mechanical data   Material data</b>	
Coating contact	Copper alloy
Coating of fitting	nickel plated
Material gasket	FKM
Material housing	PA
Material screw connection	Zinc die-casting
<b>Mechanical data   Mounting data</b>	
Mounting method	inserted, screwed, Shaking protection
Clamping range min.	4 mm
Clamping range max.	6 mm
<b>Environmental characteristics   Climatic</b>	
Operating temperature min.	-40 °C
Operating temperature max.	85 °C
<b>Conformity</b>	
Product standard	DIN EN 61076-2-101 (M12)